

# The Four Cutter - SDS Plus & MAX Through any rebar

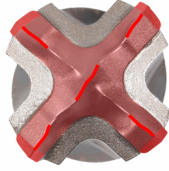

## Head Geometry

### Carbide tip:

Robust one-piece carbide tip (up to  $\varnothing 28\text{mm}$ , 3-piece from  $\varnothing 30\text{mm}$ )  
Perforates rebar with durable strength and constant precision.

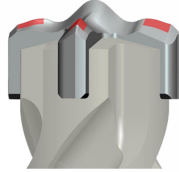

### 4 x 90° geometry:

Specifically engineered cutting edges of equal height and with strong shoulders.

Ensures dimensionally accurate holes for professional anchoring and reliable plug fixing.



### Short spiral flute entrances:

Ensure fast removal of debris



### Radial rebar protection:

Prevents jamming and increases the service life.

### Wear markers:

Indicate reliably if still suitable for drilling plug holes.

## Flute design

### 4-spiral geometry:

For comfortable smooth drilling with low vibration.  
Optimum guidance in the drill hole.



### 4x4 design:

Supports precise concentricity, minimises wear and friction losses.  
High and consistent drilling performance for the full service life.  
maximum economic efficiency.

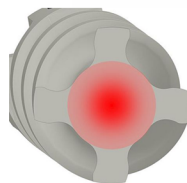

## Material

The body consists of high-grade heat-treated steel and is particularly suitable for the toughest applications.

## Product range

SDS-plus:  $\varnothing 5\text{-}26\text{mm}$

SDS-MAX:  $\varnothing 12\text{-}52\text{mm}$

